

# ENTRY-LEVEL SINGLE STATION PREMADE BAGGERS



## APPLICATIONS

- Coffee / Tea
- Confectionary
- Dry Goods
- Powders
- Nutritional Products
- Hardware
- Pet Foods
- Frozen Foods
- Bakery
- Household Chemicals
- Fresh Produce
- Pharmaceuticals
- Snack Foods
- Meats
- Cannabis
- Gummies &



## FEATURES

- Stainless steel #304 construction
- Advanced PLC control system with 7" color touchscreen control panel
- Packaging parameters may be easily set and changed
- Self-diagnostics may be viewed directly from the screen
- Statistic production overview & recording
- Fully pneumatic operating system, easy operation & maintenance
- Interlock safety door for added protection
- Easily integrated into existing packaging line
- Includes pouch infeed conveyor
- Vacuum pump for bag pickup and opening
- PID temperature control



## PACKAGE SAMPLES

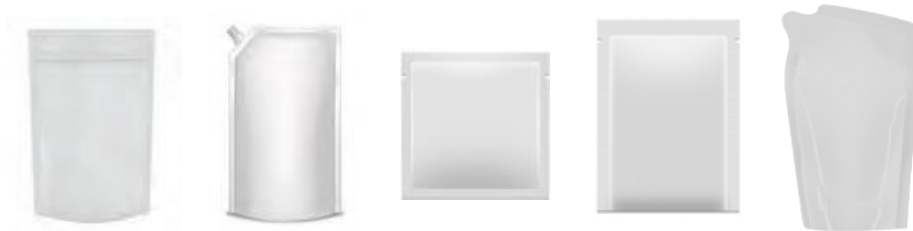

## SPECIFICATIONS

MODEL	CESS-2/300	CESS-2/430	CESS-1/300
Bag Width	100-300mm / 3.9-11.8"	100-300mm / 3.9-11.8"	100-300mm / 3.9-11.8"
Bag Length	100-300mm / 3.9-11.8"	100-430mm / 3.9-16.9"	100-300mm / 3.9-11.8"
Speeds	0-12 ppm	0-12ppm	0-12ppm
Power	220V / 60Hz / 1φ / 20A	220V / 60Hz / 1φ / 20A	220V / 60Hz / 1φ / 20A
Dimensions L x W x H	1784 x 1000 x 1650mm (70.2" x 39.4" x 65")	1784 x 1000 x 1650mm (70.2" x 39.4" x 65")	1750 x 510 x 1650mm (68.9" x 20.1" x 65")

# ENTRY-LEVEL PREMADE BAGGING SOLUTION

## OPTIONAL EQUIPMENT ATTACHMENTS



**AUGER SCREW FILLER**

Automatic weighing of various powder and granule products. Such as flour, spices, & sugar



**VOLUMETRIC CUP FILLER**

Filling dry, free-flowing materials such as granules, seeds, snacks, & small parts

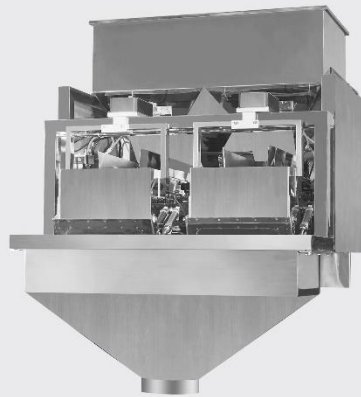

**2 HEAD LINEAR SCALE (OR 4 HEAD)**

Handle a wide variety of products, including dry goods, grains, seeds, cereals, pet foods, dried fruits/ nuts & more



**MULTIHEAD WEIGHER (10 HEADS)**

Handle a wide variety of products, including snacks, confectionary, coffee beans, bakery, hardware, cannabis, & more

## MACHINE LAYOUT

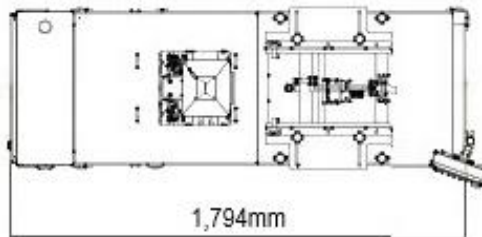
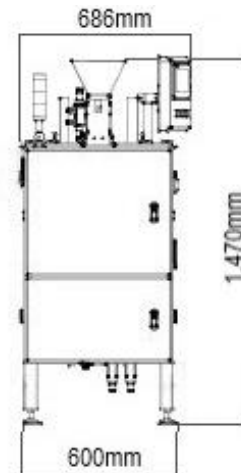
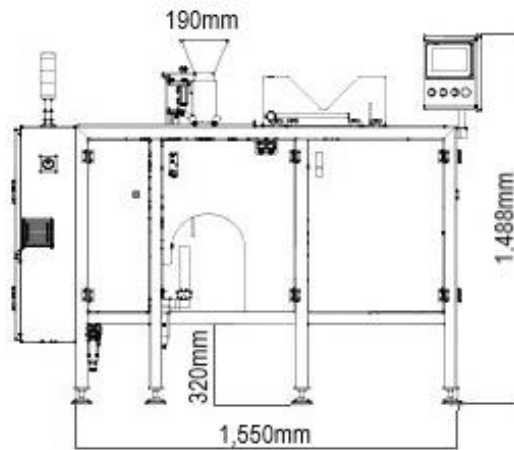
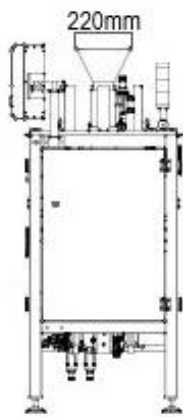

PRECISE. RELIABLE. AFFORDABLE.

226 Industrial Parkway N, Unit #3  
Aurora, Ontario L4G 4C3  
905.737.5400 | [cam-systems.ca](http://cam-systems.ca)

# HORIZONTAL PREMADE BAGGER (CHPM-210 & CHPM-210E)



## FEATURES

- Automatic 4 station Fill & Seal
- Vertical pouch feeding magazine
- Built-in vacuum pump for bag pick up
- Panasonic PLC & 7" color HMI (optional upgrade-Allen Bradley control system)
- #304 Stainless steel frame
- Interlock safety door

Model 210E



## SPECIFICATIONS

- Bag width: 100-210 mm (3.9" - 8.2")
- Vertical Bag length: 150-380 mm (5.9" - 14.9")
- Bottom gusset: 40-80 mm (1.5" - 3.2")
- Speeds are dependent on the product
  - Speeds: 25-50 ppm (210 model)
  - Speeds: 10-20 ppm (210E model)
- Bag style: flat bottom, stand-up pouch, zippered bags, semi and fully gusseted bags (210 model only)

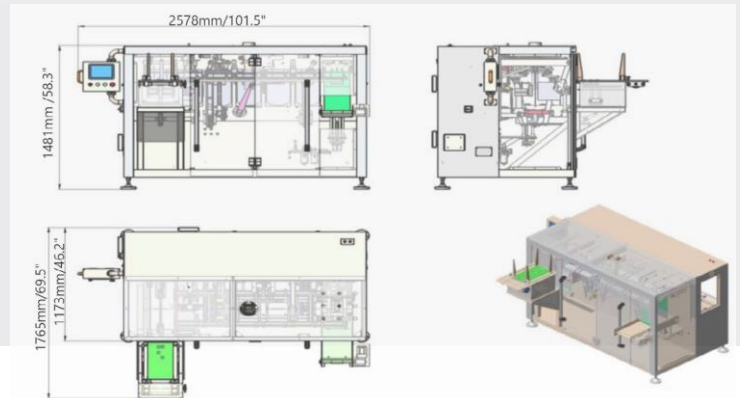
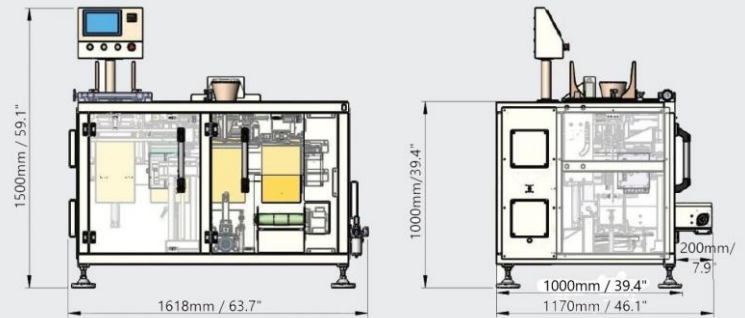

Model 210

## OPERATING FEATURES



1  
Bag Pick Up

2  
Print Area

3  
Zipper  
Opening

4  
Bottom Bag  
Opening

5  
Two Filling  
Stations

6  
Bag Closing

7  
Heat Sealing

Model 210E combines  
#2 & #3 above

Model 210E has one  
fill station



# HORIZONTAL PREMADE BAGGER (CHPM-250G)

## FEATURES

- Automatic 3 station Fill & Seal
- Vertical pouch feeding magazine
- Built-in vacuum pump for bag pick up
- Panasonic PLC & 7" color HMI (optional upgrade-Allen Bradley control system)
- #304 Stainless steel frame
- Interlock safety door

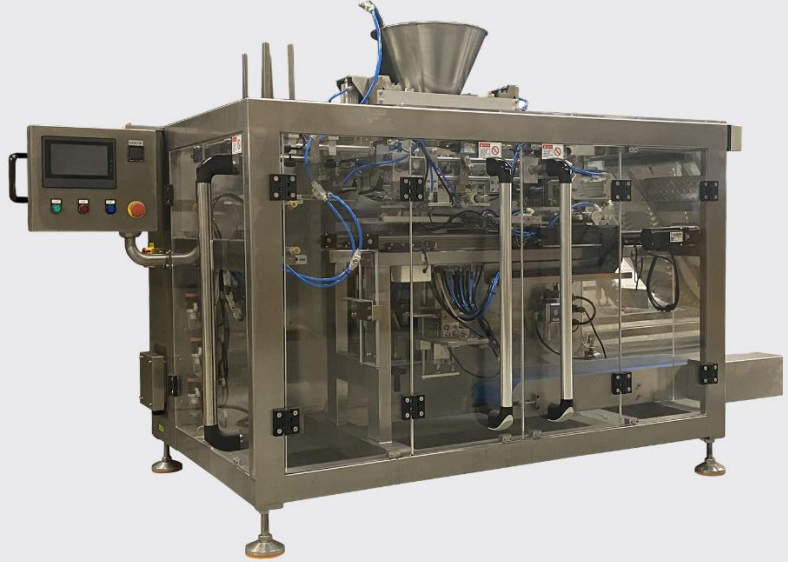

## SPECIFICATIONS

- Bag width: 100-250mm (4" - 9.8")
- Bag length: 150-400mm (5.9" - 15.75")
- Bottom gusset: 40-140mm (1.57" - 5.51")
- Speed: 8-15 ppm (dependent on product)
- Bag style: flat bottom, stand-up pouch, zippered bags and fully gusseted bags

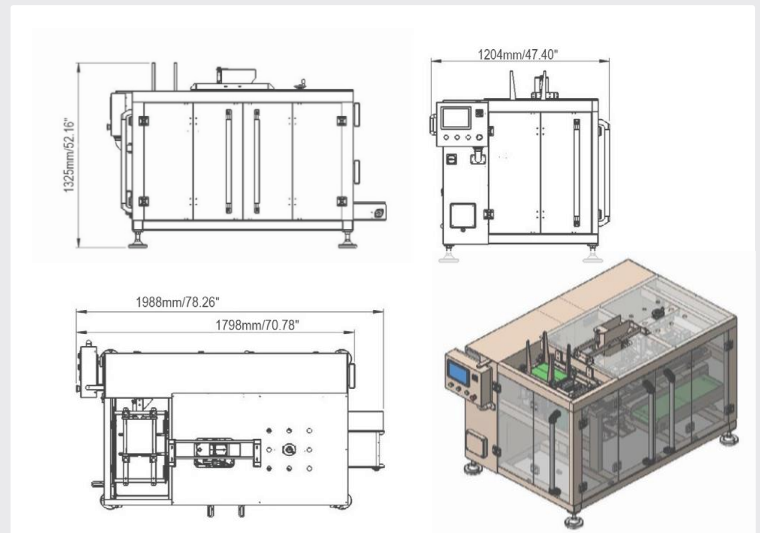

Vertical Pouch Magazine

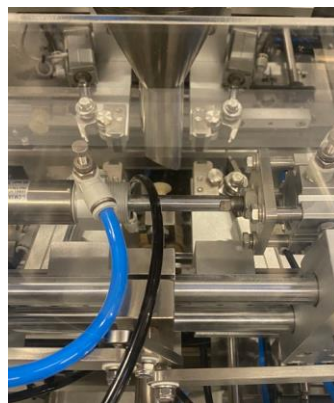

Filling Station



Bag Opening

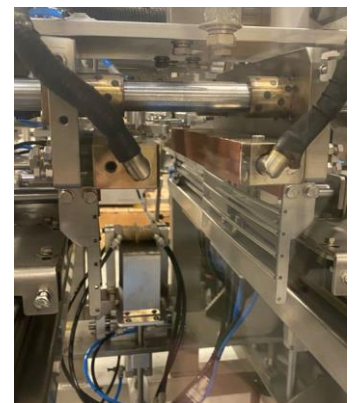

Heat Sealing

# ROTARY PREMADE BAGGER

## FEATURES

- Intermittent rotary machine with 8 stations designed for handling premade pouches such as—flat, stand-up, with or without zipper
- Easily operated, PLC controlled, and properly integrated with built-in touch screen with fault indicators, recipe optional controls, and diagnostic screens
- Easy cleaning, hygienic construction, #304 stainless steel frame
- All product contact parts are stainless steel or other materials which meet the food hygienic requirements to ensure the hygiene and integrity of the products
- Integration of various filling methods, such as auger; multihead weigher, volumetric cup filler, liquid and paste pumps, counting equipment, and pick and place systems.
- Automatic checking: no pouch or pouch open error = no fill or seal. The bag can be used again, to avoid wasting packing materials
- While the suction cups are pulling open the bottom of the pouch/bag; the windpipe releases a blast of air to open the bag fully to the bottom to avoid the material overflow from the bag if it is not opened fully.
- Simple integration of peripheral equipment



**CR8-250Z**  
8-Station Premade Bagger

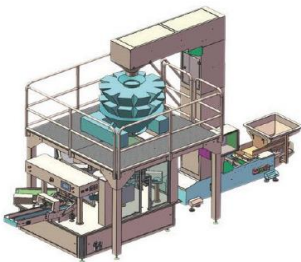

**CR8-250 MULTIHEAD  
SCALE SYSTEM**

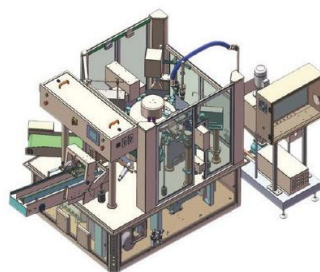

**CR8-250 ROTARY LOBE  
SYSTEM**

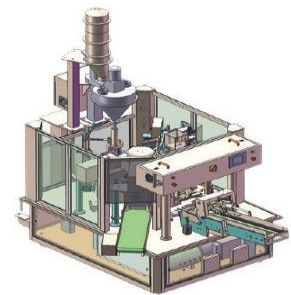

**CR8-250 AUGER  
SYSTEM**

# 8-STATION ROTARY PREMADE BAGGER

## SPECIFICATIONS

MODEL	CR 8-250	CR 8-300
Max. filling volume (ml)	2000	5000
Bag length	150-250 mm (5.9-13.75 in)	200-450 mm (7.8-17.7 in)
Bag width	100-250 mm (3.9-9.8 in)	150-300 mm (5.9-11.8 in)
Speed	20-45 ppm	15-35 ppm
Pouch format	Flat, stand up, spout, side gusset, shaped Pouch feeding conveyor	

## OPERATING SEQUENCE

### STATION #1

Pouch loading into grippers from bag loading conveyor

### STATION #2

Pouch printing station for InkJet or TTP (optional) Positive mechanical zipper opening

### STATION #3

Combined with station #4 (pouch bottom / gusset opening if present)

### STATION #4

Pouch forming and open detection with transfer arms

### STATION #5

Filling [no pouch – no fill – no seal – no loss of a pouch]

### STATION #6

Product settling station with optional gas flush

### STATION #7

Top sealing

### STATION #8

Top cooling and delivery area to the discharge belt

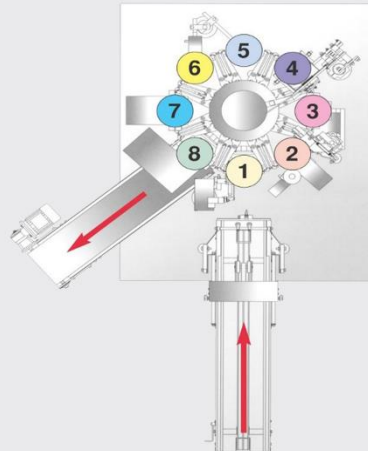
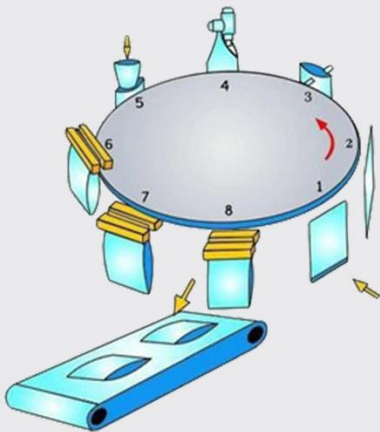

## STANDARD EQUIPMENT

- Bag infeed conveyor
- Bag opening blade with full opening detector
- P.I.D. temperature control
- Stainless steel construction
- Graphic color-touch panel
- Discharge conveyor
- Safety guards with safety switches

## OPTIONAL EQUIPMENT

- Zipper opening and closing device
- Second filling position
- Printer
- Deflator
- 45-degree transfer conveyor